



Eagles Landing Sales Office
 10 Eagles Landing Drive
 Shiloh, IL 62221
 Phone: 618-624-9653 Fax: 618-624-0179



VS1992: Located in Shiloh, IL.

1,992 Square Feet, 2 Story, 4 Bedroom, 2.5 Bath, Base Price \$186,500

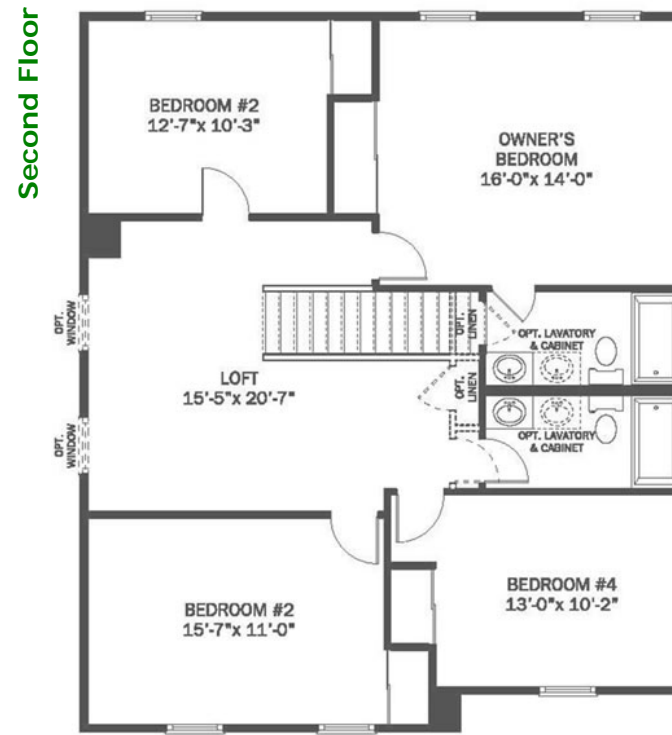
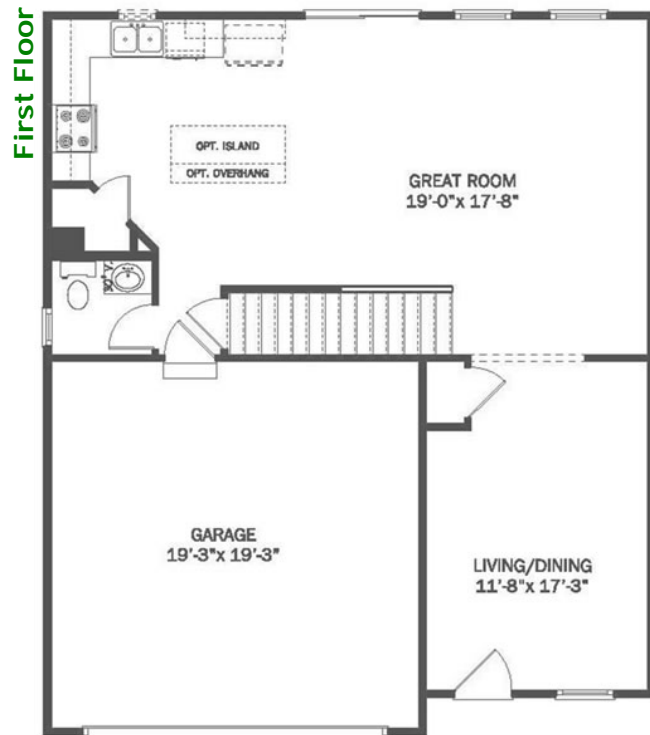

Artist's conceptual rendering. Actual construction may vary. Side entry garages, dormers, fireplaces, bay windows, sunburst garage windows, transoms, window grills some windows, porch railings, brick front porches, raised foundations, and wing walls shown on front elevations are optional. Room size dimensions shown are approximate. Due to evolutionary changes in our design improvement process, we reserve the right to substitute materials of comparable quality.

